

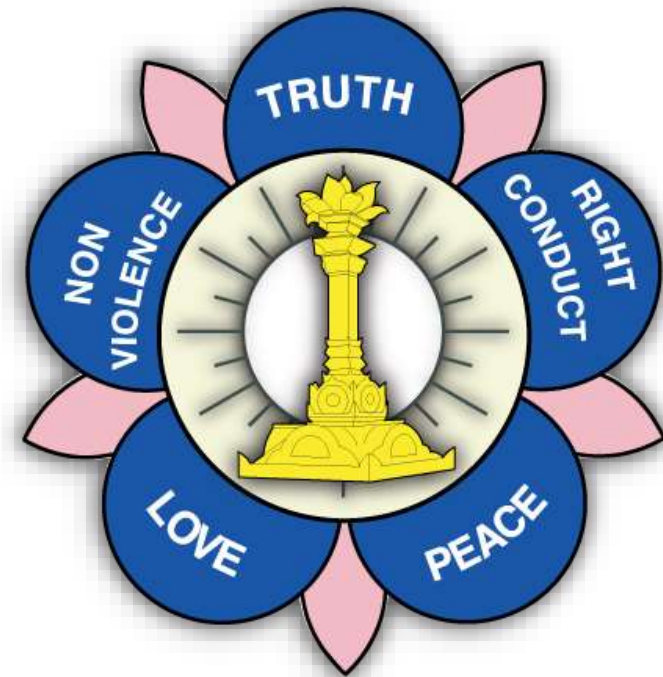

GENERAL UPDATE



SOULS

A non-profit Organization

In Support of

Sathya Sai Spiritual & Community Center in Dallas

July 12, 2020

GURU BHAJAN

<https://www.youtube.com/watch?v=A2HnBGtXgnU&t=28s>

AGENDA

1. His Mission
2. SOULS Duty
3. Summary Report - President
4. Committee Reports
 - a) Spiritual Sadhana
 - b) Building
 - c) Consultant Vendors
 - d) Finance
5. Q&A
6. Actions, Next Steps



HIS MISSION

<https://www.youtube.com/watch?v=xtlqnv1nBN0>

Sai Outreach for Up Lifting Society (SOULS) - Duty

❑ Establish *Prasanthi Dham*

- A Spiritual and Community center in North America (a satellite to Kulwant hall in Puttaparthi, India) to promote the Message of Sri Sathya Sai Baba for individual transformation and service to the community with all *Sathya Sai Baba* centers in DFW area.
- A spiritual center where Sai Devotees can feel emotionally closer to Prasanthi Nilayam.

❑ This center will meet the growing needs of community activities that includes – Education in Human Values (EHV), Devotional singing, Sathya Sai Baba Centers in Dallas, and many more

❑ Conduct activities in the areas of,

- EDUCARE – Love that Inspires (EHV & SSE classes)
- HEALTHCARE – Love that Heals (Free Health Clinics)
- SOCIOCARE – Love that Shares (Community service projects)
- ENVIROCARE – Love that Protects (Community gardens, food pantry)
- SPIRITUALCARE – Love that Transforms (Mindful living)

MAJOR MILE STONES

☐ Hrudayavasi Sai - Spiritual sadhana

- Before we install Swami in the Mandir, we are becoming aware of the Indweller of our hearts (Hrudayavasi Sai) and developing a stronger connection with this SAI - *Lead by Aruna Sampath*

☐ Land Status

- Topographical Survey completed by BURNS Surveying
- Collin county extended agricultural tax exemption for 2020 tax year
- Lease to farmer is due for extension in Aug 2020 (for 2021)
- Platting the land to our partner, VAAYU, is on hold pending master site planning

☐ Building Activities

- Finalized vendors for - Architect, Civil and Structural engineering consultants
- Building plan deliberations among SOULS team – Floor plan and 3D model
- Initiated pre-construction meetings with City of Plano

MAJOR MILE STONES

❑ New members to Prasanthi Dham project

- Srinivas Madala, Vasu Vaddaraju, & Manisha Chavva – Hrudayavasi Sai
- Surendra Mahidhara & Manisha Chavva – Added to current Building team
- Dr. Raj Reddy, Paddy Padmanabhan, & Viji Sampath - Finance Strategy team
- Dr. Raj Natarajan & Dr. Vijay Nama –Advisory Board of Trustees
- Sudhir Bhaskar - guiding on spiritual aspects to SOULS project

❑ Finance

- ACH debit module added to the bank account
- Initiated conversations for possible loan with Compass Bank; Pursuing two other leads
- 2019 IRS Tax filing completed & State Franchise tax filing in progress

❑ Website

- “saioutreach.org” is created and activated – Launch pad for broader awareness

SOULS - OFFICERS

BOARD OF TRUSTEES (BOT)

Sarma Gunturi	Board of Trustee, President
Srinivas Somisetty	Board of Trustee, Central Coordinator
Jagadish Upadhyay	Board of Trustee, Fiscal Coordinator
Dr. Vijay Nama	Board of Trustee, Advisory
Dr. Raj Natarajan	Board of Trustee, Advisory
Aruna Sampath	EC Member, Mission Coordinator
Saman Illangasanghe	EC Member, Operations Coordinator
TBD	EC Member, Communications Coordinator
TBD	EC Member, Finance and Accounting

EXECUTIVE COMMITTEE (EC)

North America – Sai Center Buildings

- ❑ Current buildings built by non-profit organizations for Sai Centers
 - Sathya Sai Baba Center of Ottawa, Carleton – Inaugurated Nov 23, 1998
 - Sathya Sai Baba Center of Toronto, York – Inaugurated Nov, 2008
 - Sarva Dharma Center in New Jersey – Inaugurated March 29, 2015
 - Sathya Sai Center of Greater St. Louis – Inaugurated Prayer hall on March 16, 2019
- ❑ Similar activities are in pursuit by
 - **SOULS in Texas**
 - Greater Boston area
 - Los Angeles, California
 - Bay area, California
 - Phoenix, Arizona

HRUDAYAVASI SAI – Spiritual Sadhana Mission

Before we install Swami in the Mandir, we are becoming aware of the Indweller of our hearts (Hrudayavasi Sai) and developing a stronger connection with this SAI

- We Cleanse our souls and Purify ourselves as we embark on this sacred endeavor to have “Prasanthi Dham” (*sacred peaceful place*) in our midst
- We yearn for our Divine Mother & Father to continue to guide us and shower us with His Grace.
 - Together in Harmony and Unity, as one voice, we will chant prayers, affirmations, Sai Gayatri, and introspect on Swami’s teachings
- We Pray & Affirm without specifics on the size, the cost, and the timeline
 - With full faith, we surrender the results to our Divine Guru Sathya Sai Baba as He is the one Omniscient, Omnipresent and Omnipotent God
- We are grateful to all the participants for all their support!
 - As we practice this Sadhana we remain open for any and all possibilities that Baba may bless us with.

HRUDAYAVASI SAI – Group Sadhana

- ❑ Weekly Group Sessions (30 minute duration) for devotees,
 - On Mondays (8 pm) and Saturdays (10 am)
- ❑ A SESSION is conducted as follows:
 - Invoking Swami through Prayers.
 - Meditation – Soham Meditation & Dr. Sola's Meditation
 - Affirmations - We yearn for a permanent, safe and spacious place for Prasanthi Dham with an enduring Unity among us
 - Visualization - of having Prasanthi Dham in our midst (without any specifics of time , cost , size etc.)
 - Baba's message to introspect on.

HRUDAYAVASI SAI – Daily Spiritual Sadhana

INDIVIDUAL EFFORT IS NEEDED AS WELL AS GROUP EFFORT!

- Chant Prayers** - *Any prayers of your liking*
- Say Affirmations** - *We yearn for a permanent, safe and spacious place for Prasanthi Dham with an enduring Unity among us*
- Practice Meditation** – *Soham Meditation & Dr. Sola’s Meditation*
- Revel in the Joy** - *of having Prasanthi Dham in our midst (without any specifics of time , cost , size etc.)*
- Introspect** – *on Baba’s message from the video shown – “How to be Always Blissful”*
- Join Group Sadhana sessions** - *Once a week and help energize and raise our group consciousness to higher levels!*

PRASANTHI DHAM - BUILDING DETAILS

❑ The building is planned,

- Area is 30,000 SqFt, Estimated cost of \$4.5M
- For Net-Zero (solar panels, geo-thermal heat pumps, rain water harvesting with zeroscaping, Community garden)
- Has two wings – EAST & WEST wings

❑ EAST wing is for Devotional Activities

- It will be a replica of Kulwant Hall at Puttaparthi
- Accommodates 500 people and up to 1000 during special occasions

❑ WEST wing is for Outreach Activities

- Multipurpose area to host free clinic, multi-faith, and other community events
- It will have all the classrooms that holds 250 children in a single session
- Kitchen and Food pantry for Sociocare activities

High Level Project Layout

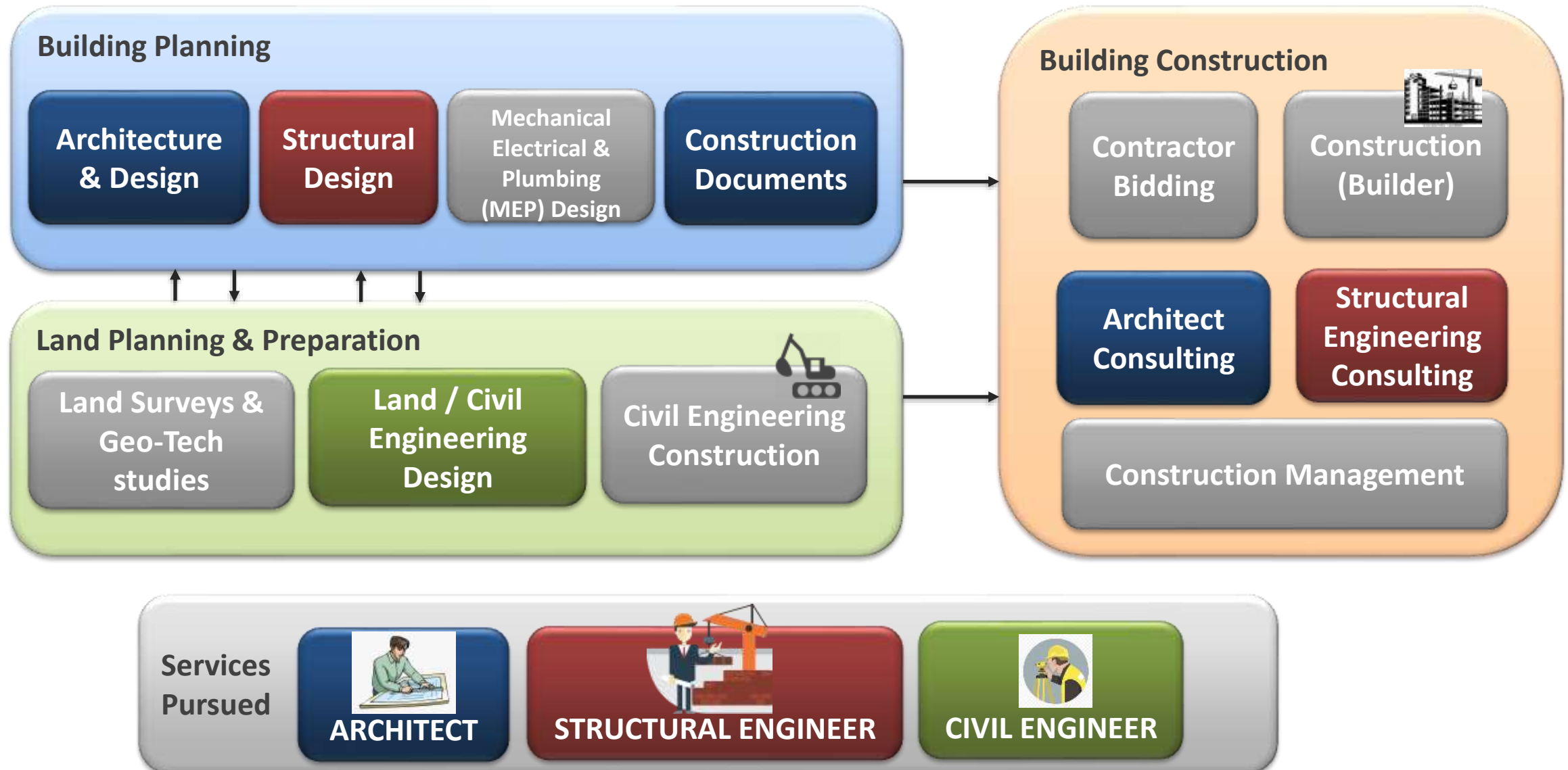

CHOSEN BUILDING CONSULTANTS

ARCHITECT

- Pre-design, Master planning, Schematic blocks, Design development, Construction Documents
- Coordination with owner, City, Structural & Civil engineers, and other key players
- Comply and seek city permits; Building design in accordance to owner's needs and budget



STRUCTURAL ENGINEER

- Design and structural details for main building, foundation, framing, paved concrete, parking lot
- Coordination with owner, City, and Architect
- Comply to seek city permits; Should be certified PE in Texas



CIVIL ENGINEER

- Analysis and Plans for - Drainage, Paving, Erosion, Fire lane, Utility, Sewer & water lines
- Traffic control analysis, Site/Parking layout, Landscape, Lighting, Signage, & Misc. Civil details
- Works in coordination with Owner, City, and Architect



Tim Konganda

- Frisco Hanuman temple
- Temples (KSHT, Radhakrishna, Balaji, Shirdi-Plano & Irving), Educational (DFW & other ISD)
- Eager & flexible to work, Full range of services, Knows Sathya Sai, Local, Reasonable Fees





BETA, Inc.

Bengal Engineering & Technology Associates, Inc.

- Sai center devotee's friend
- Community & commercial buildings, Major projects with DART, Transport
- Retired but practicing; desire to give back to community, forthcoming to help us

Suku Banerjee
Subal Sarkar

SUMMARY OF DESIGN WORK ITEMS

Work Items	 ARCHITECT	 STRUCTURAL ENGINEER	 CIVIL ENGINEER
Common to SOULS & VAAYU	<ul style="list-style-type: none"> Master property layout/Plan 	<ul style="list-style-type: none"> Structural design of common parking lot 	<ul style="list-style-type: none"> Land design City approvals
SOULS Specific	<ul style="list-style-type: none"> SOULS building design Project manage all teams City approvals 	<ul style="list-style-type: none"> Structural design of the SOULS building 	<ul style="list-style-type: none"> None
Fee	<ul style="list-style-type: none"> \$120,000 	<ul style="list-style-type: none"> \$32,000 	<ul style="list-style-type: none"> \$38,000

Pre-Requisites:

- Topographic survey: \$1450 (Burns Survey)
- Geotechnical survey: \$5k - \$8K (TBD)

LAND AND PARKING - DEVELOPMENT

Cost Estimate: ~\$750K
Completion Date: Gurupoornima 2021

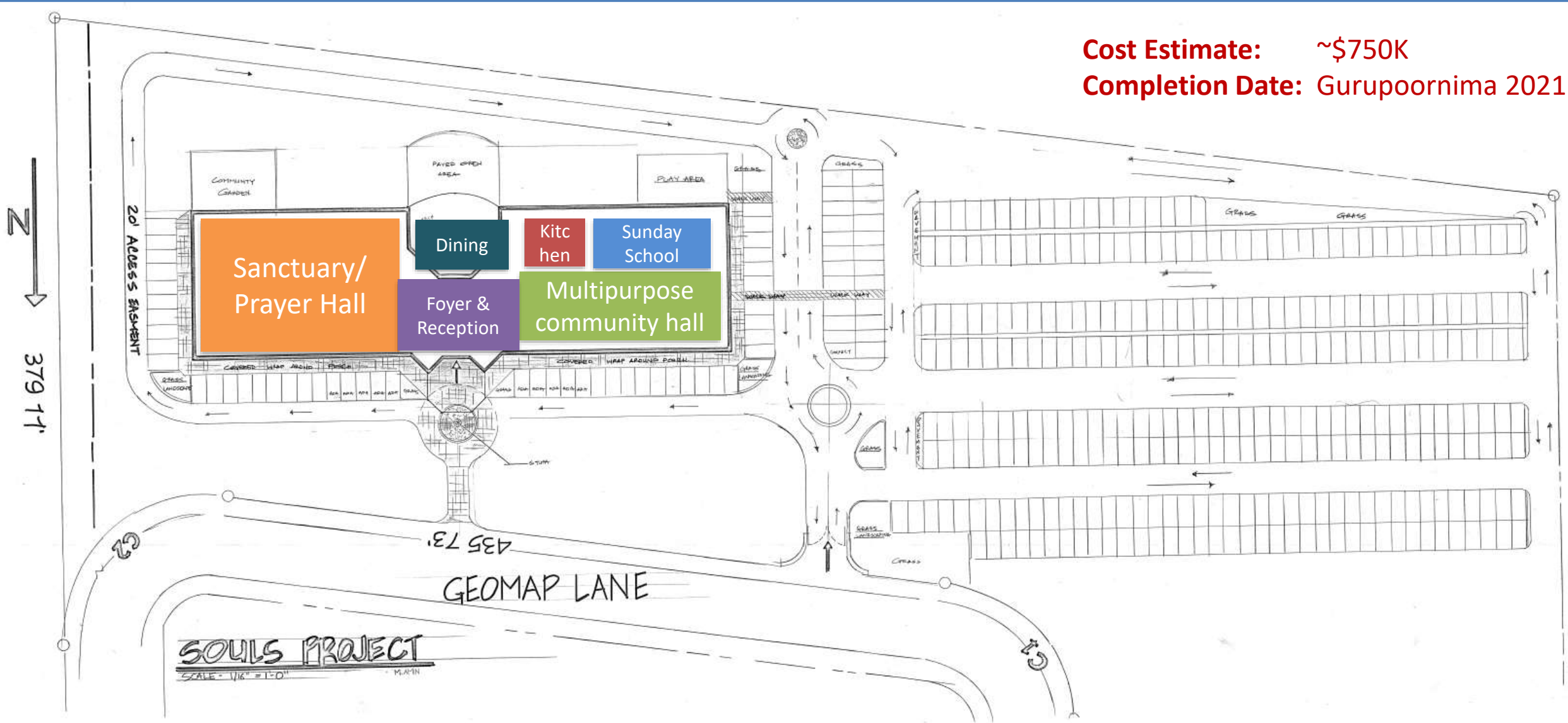

BUILDING LAYOUT

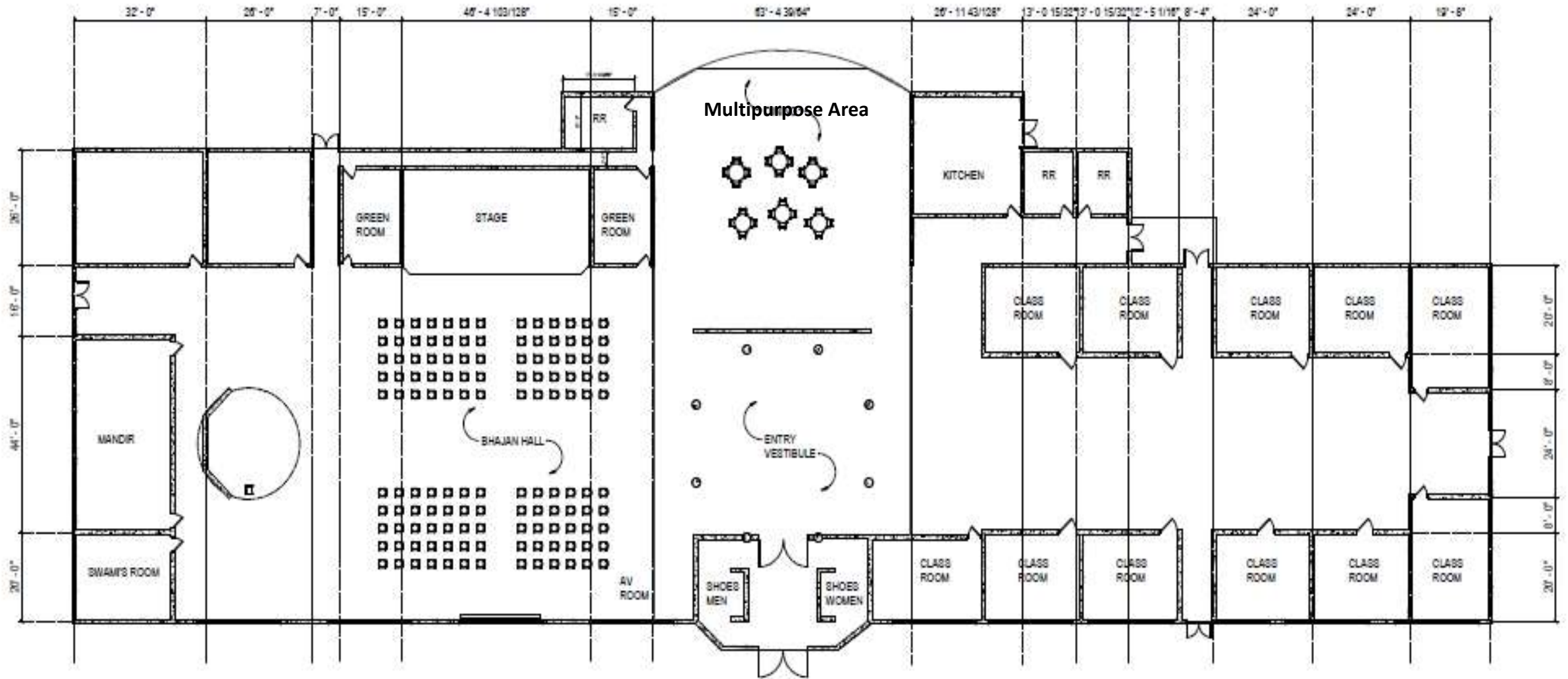

BUILDING PLAN - INSPIRATION



Kulwant Hall in Prasanthi Nilayam



**Super
specialty
Hospital
Lobby
In
Bangalore**



DESIRED ALTAR



Play (k)

Front of the Altar, Kulwant Hall in Puttaparthi

From back of the Altar



DESIRED BHAJAN HALL (SANCTUARY)



DESIRED LOBBY (SSIHMS – Bangalore)



DESIRED LOBBY (SSIHMS – Puttaparthi)

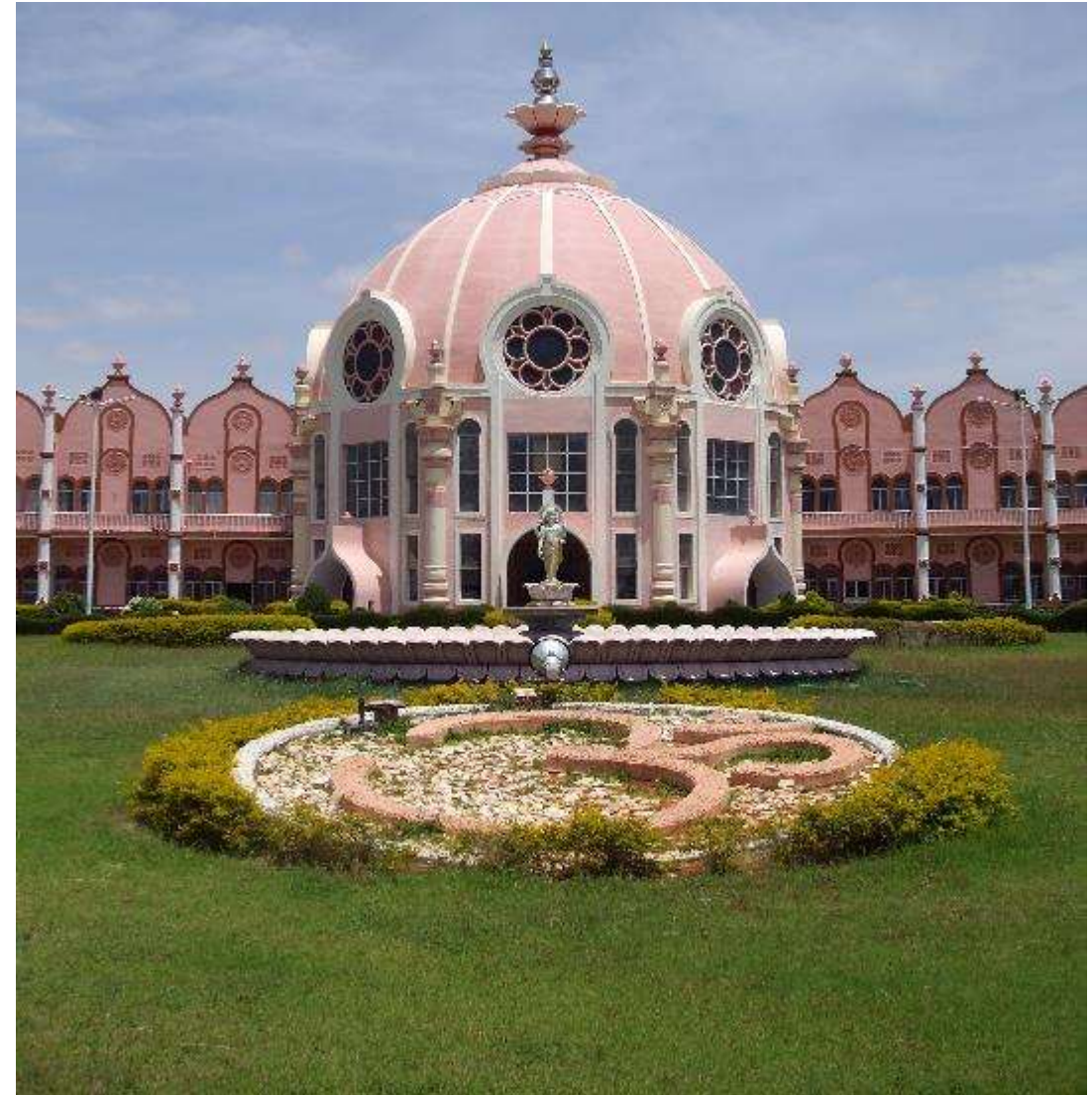

BUILDING PLAN - MODELING



Balsa wood model made at home

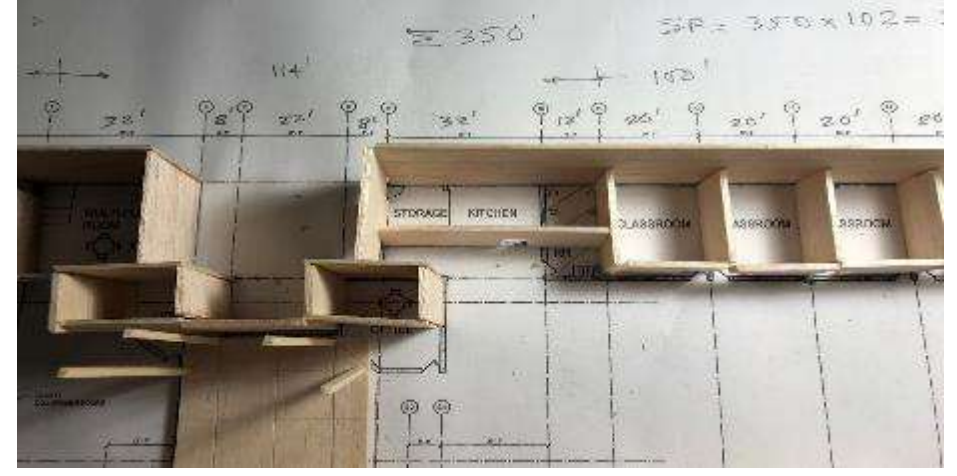
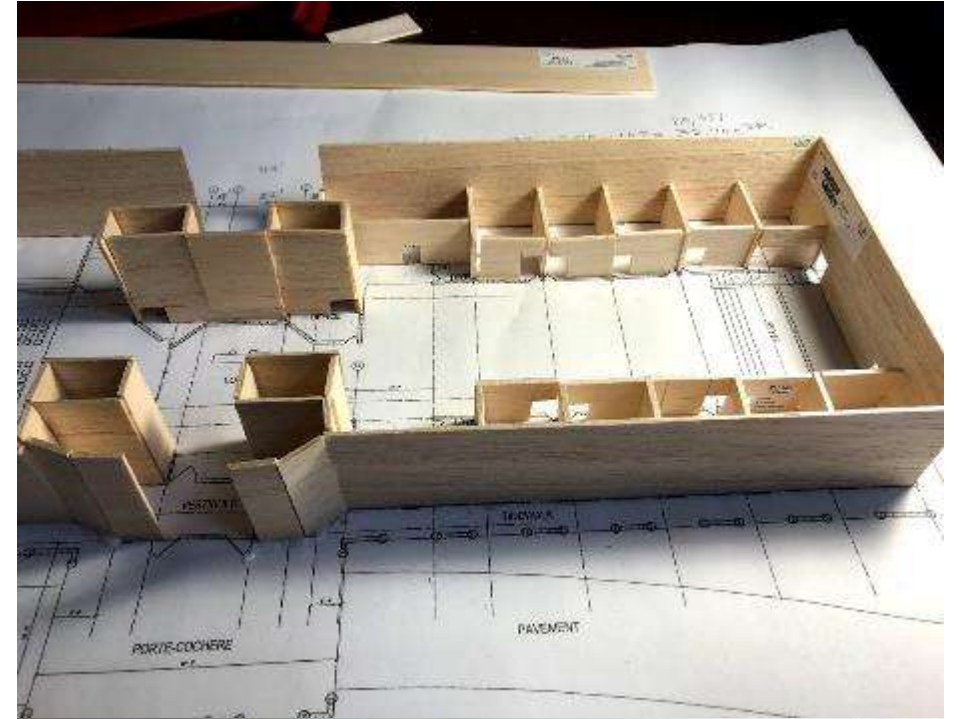

3D CAD MODEL (Evolving) - Exterior



FRONT VIEW

BACK VIEW

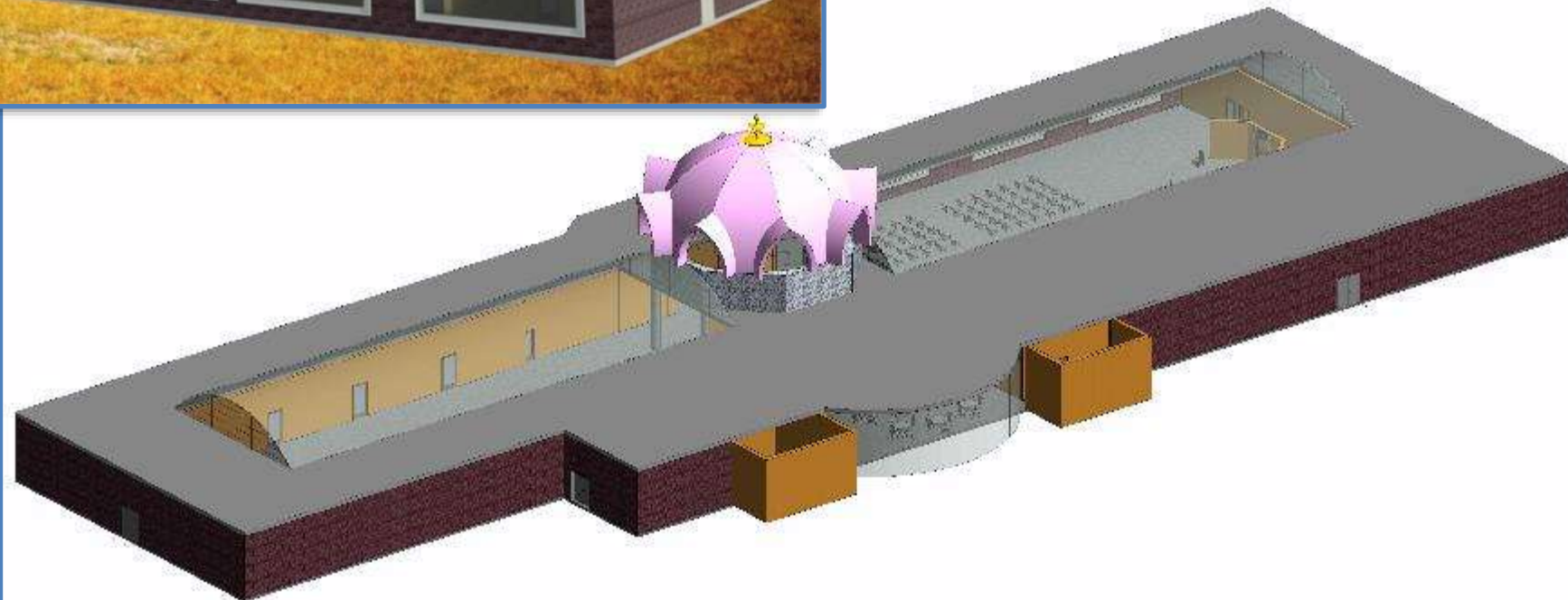

3D CAD MODEL – Interior (Lobby & Bhajan hall)



ENTRY LOBBY

MAIN SANCTUARY / BHAJAN HALL



Virtual Walkthrough of Prasanthi Dham (preliminary visual)

TARGET MILESTONES

Task	Target Date
Finalize vendors for Architect, Structural Engineer, MEP, & Civil engineering Design	May 2020
Civil Engg-Land design complete	Sept 2020
Civil Engg-Land construction (including Parking lot) complete	Dec 2020
Entitlement from City with Building Construction Document	March 2021
Seek contractor bids	April 2021
Contractor finalization	May 2021
Land Prep Completion & Building ground breaking	July 2021 (Gurupoornima)
With Swami's grace we pray for Facilities move-in on His Birthday	Nov 2022



CONTRIBUTIONS TO THIS PROJECT

- Target for first milestone (*Land preparation & Parking lot*): \$750K
- Multiple ways to contribute
 1. Regular contributions - *\$100 - \$500+ made with Monthly ACH contributions*
 2. Mail a physical check
 3. PayPal on the SOULS website
 4. Bill pay facility from your bank
- The contributors could adopt specific parts of the '*Prasanthi Dham*'
 - e.g. altar, classrooms, multi purpose rooms, kitchen, pantry, library, etc.)
- Explore for matching from corporate funds – *stretch the dollars*
- Any other thoughts?

ACH

- ❑ ACH Debit Module is added to the SOULS' bank account
 - ACH stands for Automated Clearing House, a U.S. financial network used for electronic payments and money transfers.
 - Also known as “direct payments,” ACH payments are a way to transfer money from one bank account to another without using paper checks, credit card networks, wire transfers, or cash
 - This will make the contributions simpler, an online process, and periodic
 - Provide – Bank account & routing number information & monthly amount
 - Monthly target - \$15,000 & is debited 9th of every month (for monthly operating expenses)
- ❑ 2019 IRS tax filing completed & State franchise tax filing under progress

Membership and Communications

- ❑ Every individual (18+) of a family must register to be a member
- ❑ SOULS current Email List
 - Members List (129)
 - I am interested list (100+)
- ❑ Membership link is on the website (www.saioutreach.org)
- ❑ Need Help - to develop and maintain the SOULS website
- ❑ Email address: souls.exec@gmail.com

New Website – SAIOUTREACH.ORG

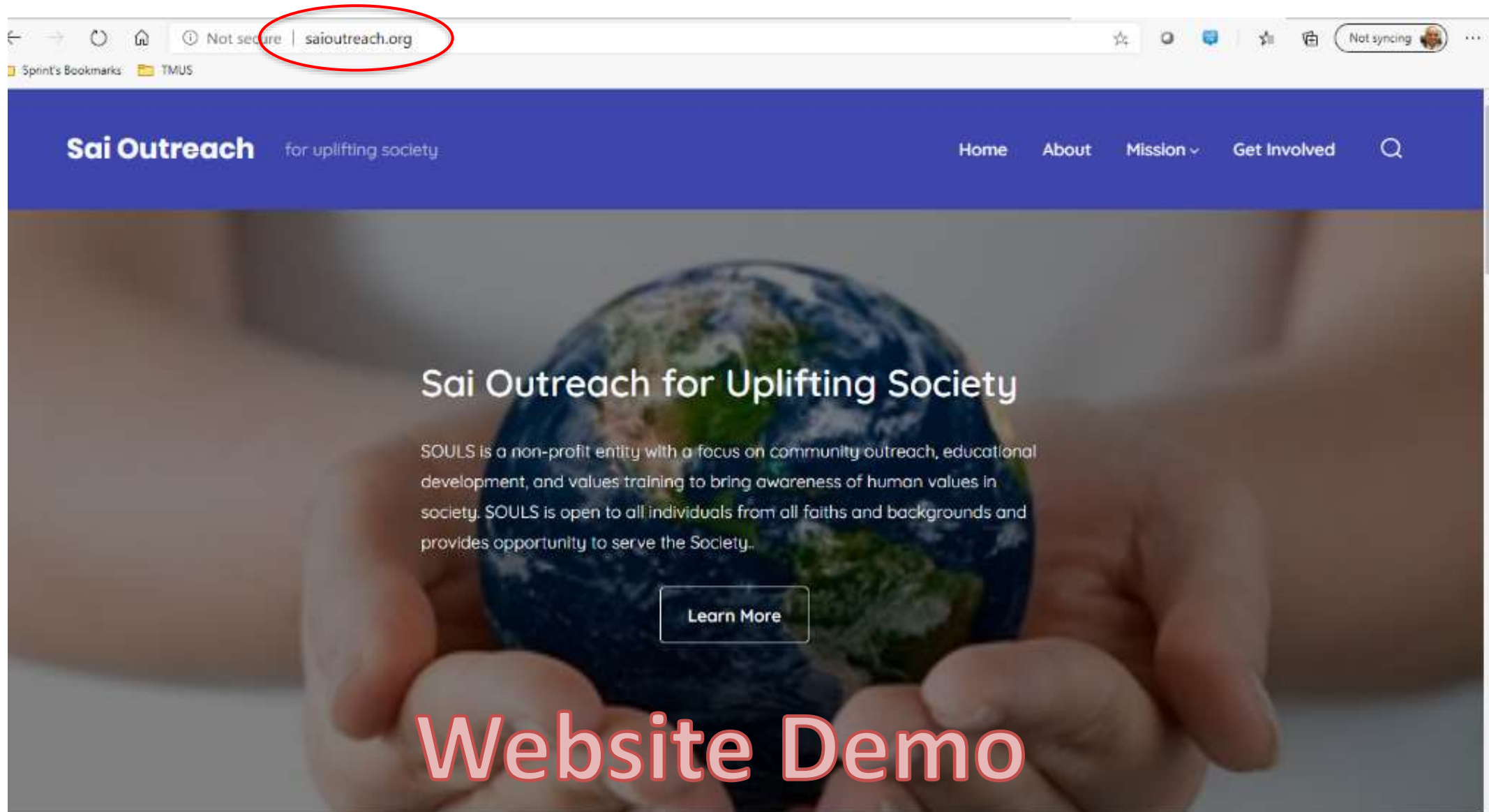

Q&A

Open discussion



Dedicated At The Lotus Feet